

The Model 5670 is designed to reduce high inlet pressures to working pressures. Careful design and quality materials throughout assure long, trouble-free operation in the most difficult industrial environments.

Specifications

Connections: 0.25 FNPT
 Operating Temp.: -70 to +225°F
 Max Inlet Pressure: 5500 psig
 Flow Capacities: see Table 1
 Outlet Ranges:
 • 0 - 125 psi
 • 0 - 150 psi
 • 0 - 225 psi

Features:

- **Quality Assurance Testing** - All 5670 Regulators are hydrostatically tested and function tested to ensure satisfaction.
- **NACE Compatibility** - Wetted parts conform to NACE MR-01-75 specifications for sour gas service.

Materials of Construction:

- Body / Bonnet 316 SST
- Diaphragm 302 SST
- Seat Nylon
- Seals TFE & Viton
- Nozzle 316 SST
- Filter 40 Micron Screen



Ordering Information

Maximum Outlet Pressure	Adjusting Screw	Model Number
125 psi	Slot	5670-1
150 psi	Slot	5670-3
225 psi	Slot	5670-5



Table 1. Flow Capacities, Scfh of Air (based on 20% droop)

Spring Range	Outlet Pressure Setting		Inlet Pressure, PSIG (Bar)						
			100 (6.8)	250 (17)	500 (34)	750 (51)	1000 (69)	1500 (103)	2000 (137)
	Psig	Bar							
0-125	25	1.71	290	480	650	750	770	800	820
	50	3.42	400	800	1000	1200	1300	1400	1500
	75	5.14	400	900	1400	1600	1700	1800	1900
0-150	75	5.14	350	800	1300	1500	1600	1700	1800
	150	10.3	-	1000	1800	2300	2600	2800	3000
0-225	150	10.3	-	900	1700	2200	2250	2750	3000
	225	15.4	-	800	2100	2900	3500	4000	4500

Dimensions

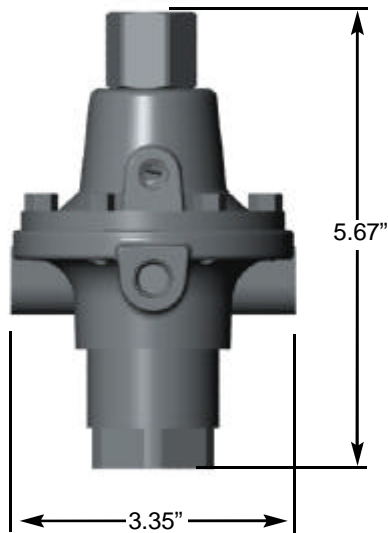

While this information is presented in good faith and believed to be accurate, Mallard Control Company does not guarantee results based upon such information. Mallard Control Company reserves the right to change the design or specifications of these products without notice.

Mallard Control Company, Inc.

4970 Washington Boulevard
 Beaumont, Texas, USA 77707
 409 842-5392 Phone
 409 842-8165 FAX
www.MallardControl.com